

C O D A
C O D A A U D I O



AC24 User Manual

Version 1.1

AC24 Analogue Signal Processor

Features

- 2-inputs, 4-outputs
- Full range mode
- Monitor mode
- Subwoofer/Sattelite mode
- 24 dB/octave Linkwitz--Riley crossovers
- Subsonic filters
- High frequency EQ
- Optical limiters
- 3 position for amp sensitivity: 0dB, +3dB, +6dB
- Maximum dynamic range

The AC24 stereo controller contains two inputs and four outputs providing crossover, equalization and limiter functions to optimize the frequency response of all Coda passive cabinets either in full range, stage monitoring or in combination with subwoofers. Utilizing different modules the AP24 is precisely matched to the Coda Audio D-series, K-series and Rx-series cabinets.

AC 24 Chassis are available in two basic versions: Standard-VS and Large-VL.

Please use the AC 24VS - Standard Chassis for the following subwoofers: PW 112, PW 115, PW 118, PW 215



Please use the AC 24VL - Large Chassis for the following subwoofers: PW 12, PW 418



Each output has optical limiter with selectable output level (LIMITERS TRESHOLD) on rear panel, according to the sensitivity of the used amplifier. For example, if your amp has a 0dB (0.775V) input sensitivity, the LIMITERS TRESHOLD switch must be in 0dB position.



An AC24 has two balanced inputs and four balanced outputs, two high and two low

- LEFT/RIGHT,
- LEFT/RIGHT,
- SUB LEFT/SUB RIGHT.

TECHNICAL SPECIFICATIONS:	
Inputs	Electronically balanced 11 kOhm input (pin 2 hot)
Outputs	Electronically balanced 600Ohm Output (pin 2 hot)
Input Headroom	+ 22 dB
S/N Ratio low outputs	≥ 86 dB
S/N Ratio high outputs	≥ 94 dB
Dynamic Range	≥ 108 dB
THD	≤ 0.01% (20 Hz to 20 kHz at 0 dB)
Front + Rear Side:	
Input Level Indicators	- 20 dB green 0 dB yellow + 6 dB red (for each channel)
Limiter Indicators	Red for each output
Volume	0 to 10 for both channels
Sub level	-/+ 6 dB for both channels
High EQ	- 3 dB 0 dB + 3 dB
mode	Monitor / Full / Top-Sub
Limiters Treshold	0 dB + 3 dB + 6 dB
Lift-GND	Switch on rear panel
Power	230 or 115 VAC, 50 - 60 Hz, 20 V A
Physical:	
Finish	Black and blue with light grey text
Dimensions H x W x D	1 U, 44.4 x 483 x 210 mm, 1.75" x 19" x 8.3"
Net weight	2.8 kg
Shipping weight	3.3 kg
Shipping dimensions:	95 x 510 x 275 mm, 3.75" x 20" x 10.8"

Each Chassis can use 4 different exchangeable modules - L, M, S and UC. Please use the following modules for different full range cabinets:

Controller	Cabinet
Module-UC	D5, K4, K5
Module-S	D8, K189/K189-Pro, K289/K289-Pro
Module-M	D12, K12v ² , Rx32M, Rx40
Module-L	K15v ² , Rx35, Rx36M

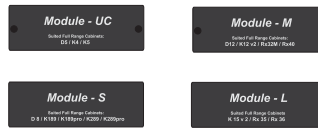

AC24 Block Diagram

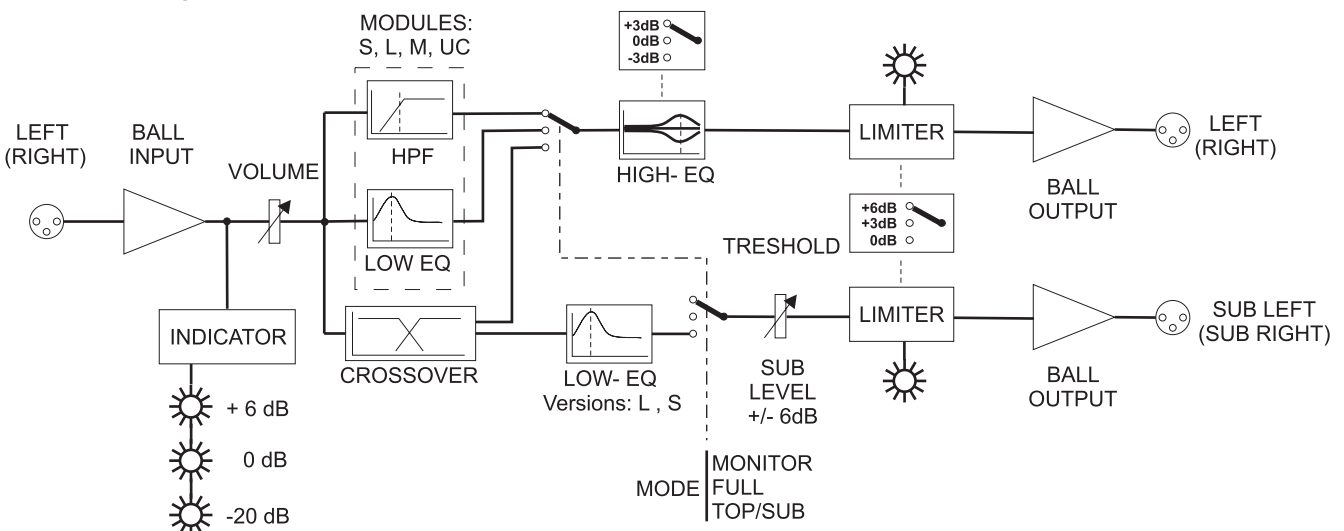

How to use the AC24 Analog Signal Processor

mode - FULL RANGE

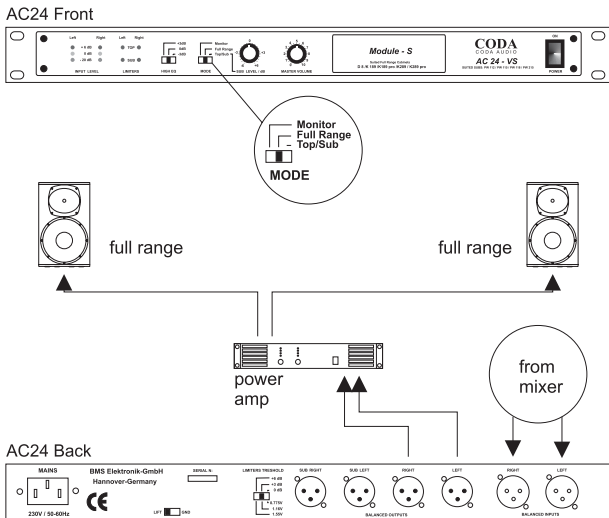

In **Full Range** mode the AC24 provides:
Stereo subsonic filters, bass EQ, High EQ
for room compensation and limiters.

mode - MONITOR

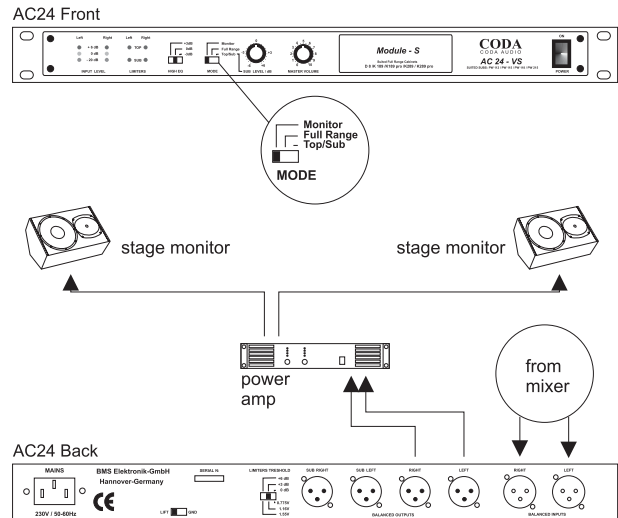

In **Monitor** mode the AC24 provides:
Stereo subsonic filters, half space compensation
for floor coupling, High EQ and limiters.

mode - TOP/SUB

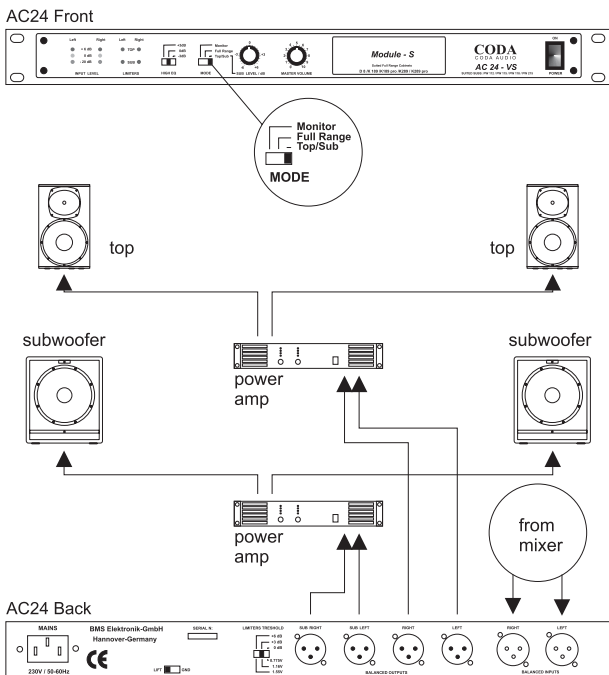

In **Top/Sub** mode the AC24 provides:
Stereo 24dB Linkwitz-Riley crossovers, subsonic
filters, bass EQ, High EQ for room compensation
and limiters for all four outputs.

The AC24 stereo controller contains two inputs
and four outputs.

High-equalization, selectable by switch on the front panel,
is provided on high outputs in all 3 modes.
Those modes are selectable with four panel switch:
TOP-SUB, FULL RANGE and MONITOR

Although the K-series and Rx-series loudspeakers
incorporated dedicated passive crossovers ensuring linear
frequency and phase response allowing them to work
without additional processing, the use of the AC24
processor improves dramatically the overall system
performance offering protection and frequency response
optimization either in full range, stage monitor
applications or in combination with subwoofers.

Using the cabinets together with the AC24 controller, the
recommended Coda Audio subwoofers and high quality
amplifiers allows you to create systems ideally suited for
live bands, clubs, corporate events and Front-of-House
applications.

Ver AC24-L

MODE		Crossover frequency	Low- EQ frequency	Low-EQ	HPF frequency	HPF	High - EQ
Top-sub	Two - way	80Hz- 24dB/oct/L/R	32Hz	+6dB	32Hz	18dB/oct	+/- 3dB
Full - range	One-way		50Hz	+10dB	50Hz	18dB/oct	+/- 3dB
Monitor	One-way				50Hz	12dB/oct	+/- 3dB

Mode TOP-SUB

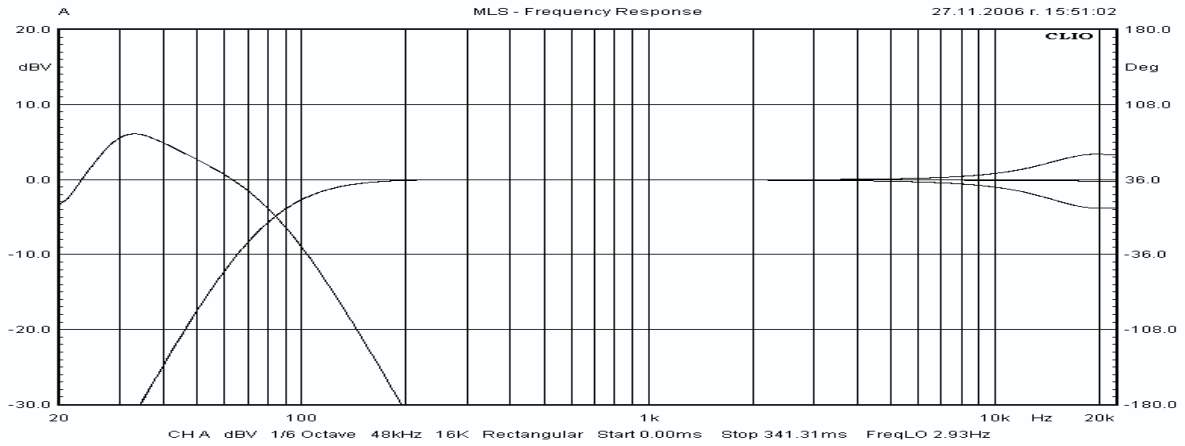

Mode Full range

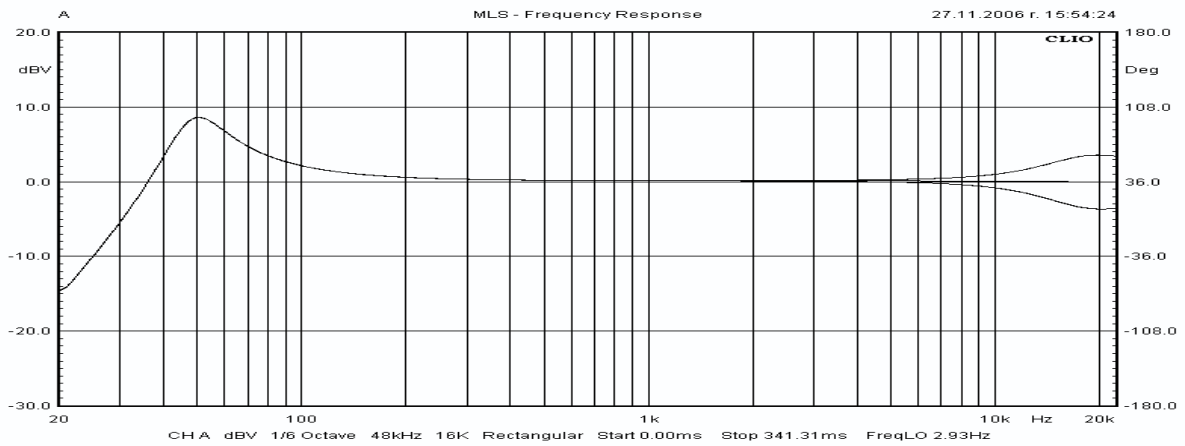

Mode Monitor

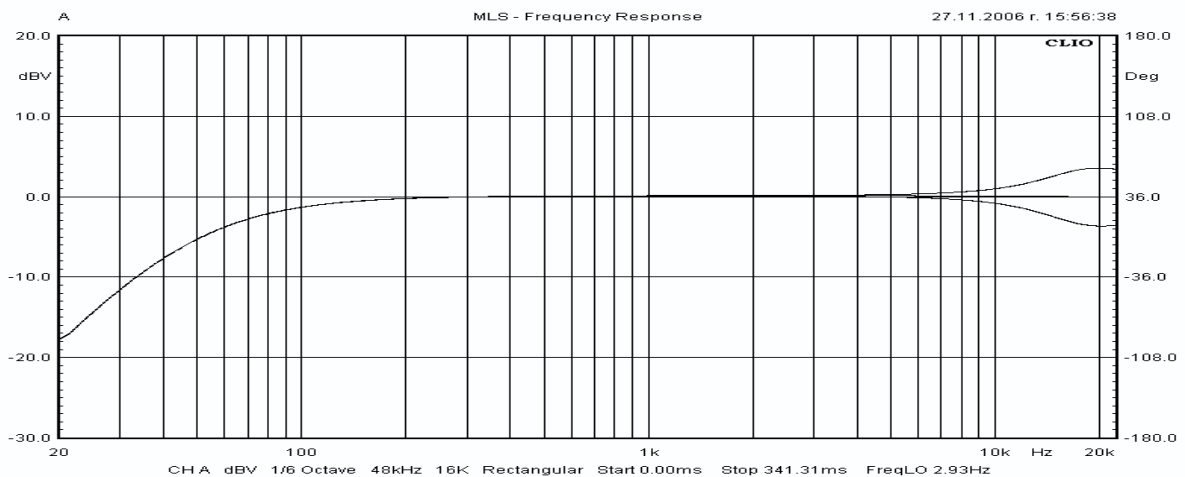

AC 24 Measurements

Ver AC24-M

MODE		Crossover frequency	Low- EQ frequency	Low-EQ	HPF frequency	HPF	High ! EQ
Top-sub	Two - way	100Hz- 24dB/oct/L/R	40Hz	+10dB	40Hz	18dB/oct	+/- 3dB
Full - range	One-way		60Hz	+10dB	60Hz	18dB/oct	+/- 3dB
Monitor	One-way				60Hz	12dB/oct	+/- 3dB

Mode TOP-SUB

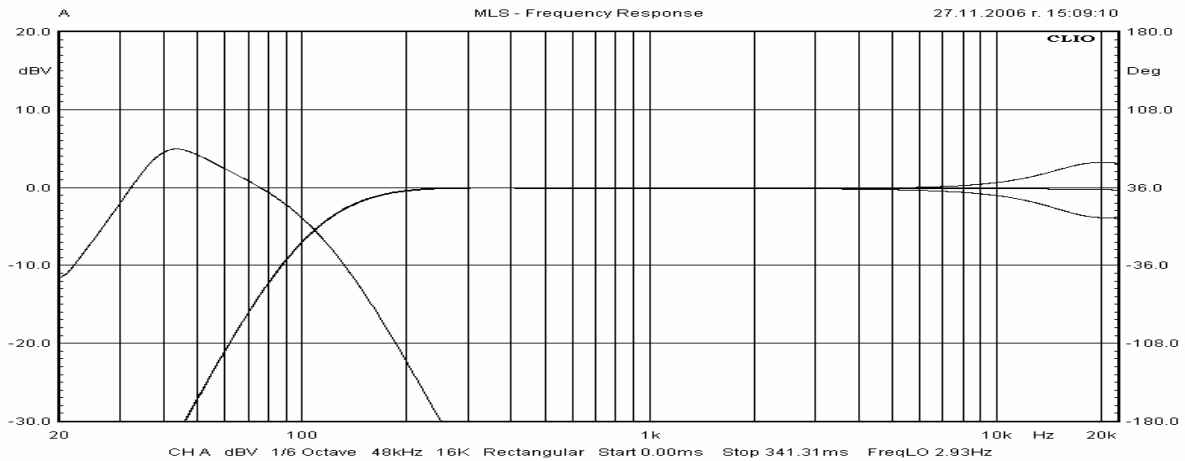

Mode Full range

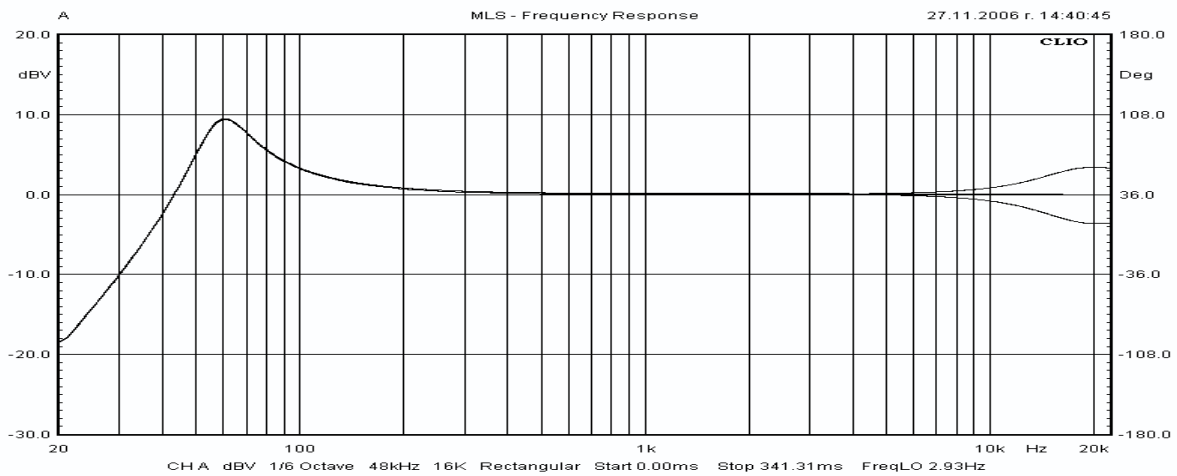

Mode Monitor

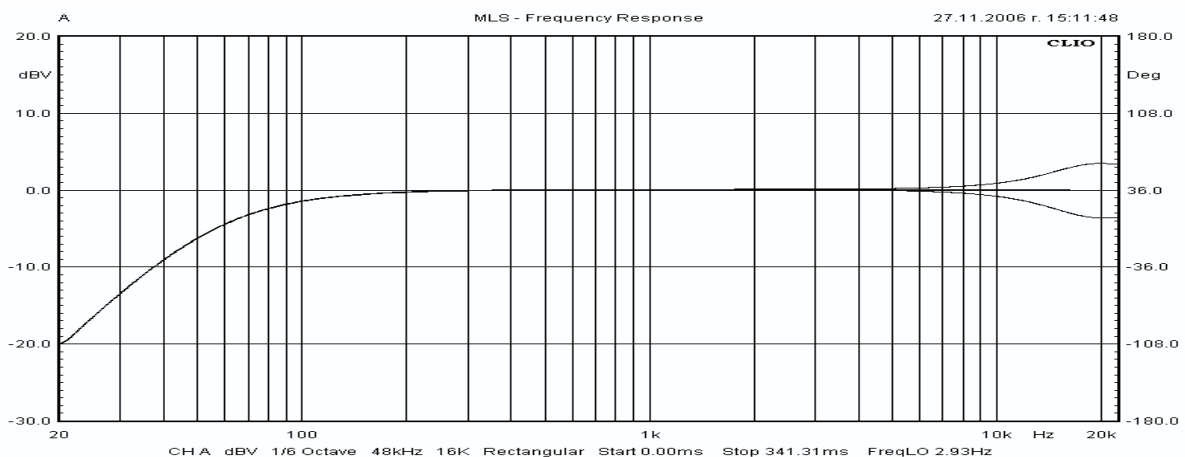

Ver AC24-S

MODE		Crossover frequency	Low- EQ frequency	Low-EQ	HPF frequency	HPF	High - EQ
Top-sub	Two - way	100Hz- 24dB/oct/L/R	40Hz	+10dB	40Hz	18dB/oct	+/- 3dB
Full - range	One-way		80Hz	+10dB	80Hz	18dB/oct	+/- 3dB
Monitor	One-way				80Hz	12dB/oct	+/- 3dB

Mode TOP-SUB

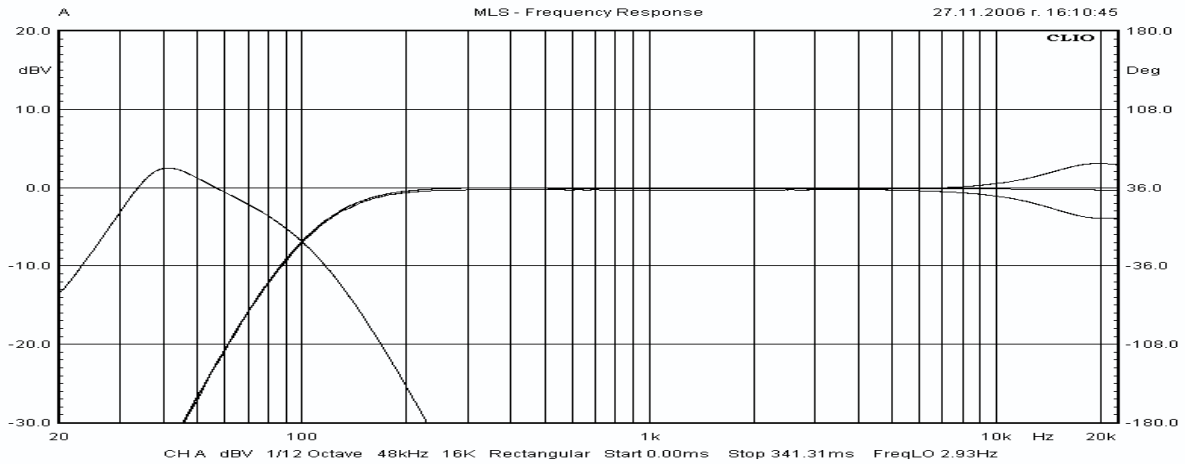

Mode Full range

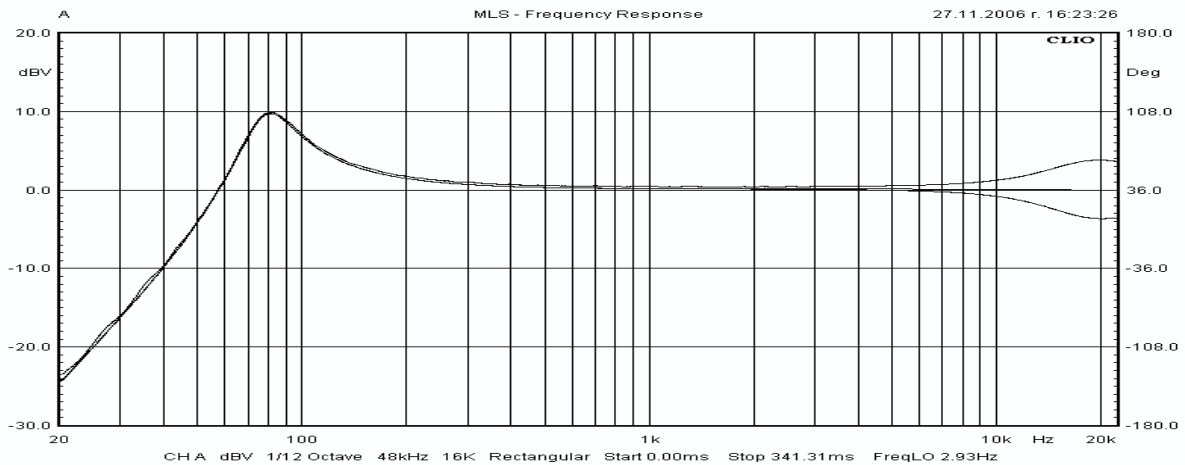

Mode Monitor

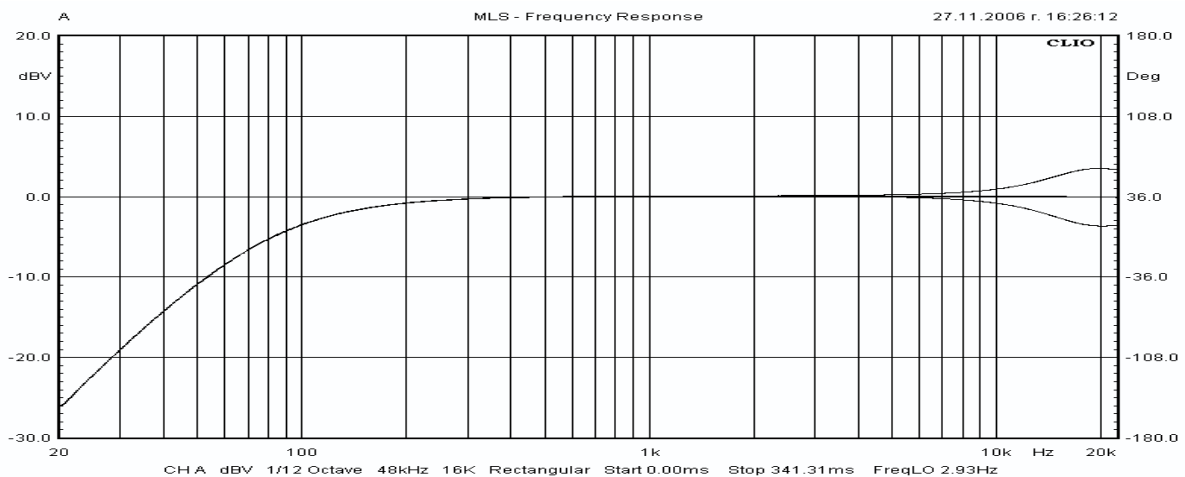

AC 24 Measurements

Ver AC24-UC

MODE		Crossover frequency	Low- EQ frequency	Low-EQ	HPF frequency	HPF	High - EQ
Top-sub	Two - way	100Hz-24dB/oct/L/R	40Hz	+10dB	40Hz	18dB/oct	+/- 3dB
Full - range	One-way		100Hz	+6dB	100Hz	12dB/oct	+/- 3dB
Monitor	One-way				100Hz	12dB/oct	+/- 3dB

Mode TOP-SUB

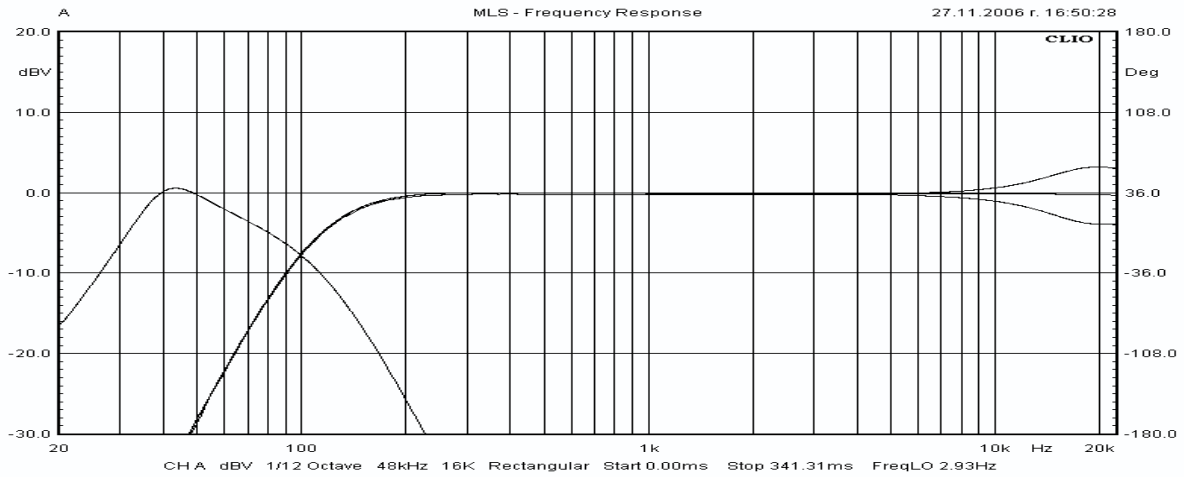

Mode Full range

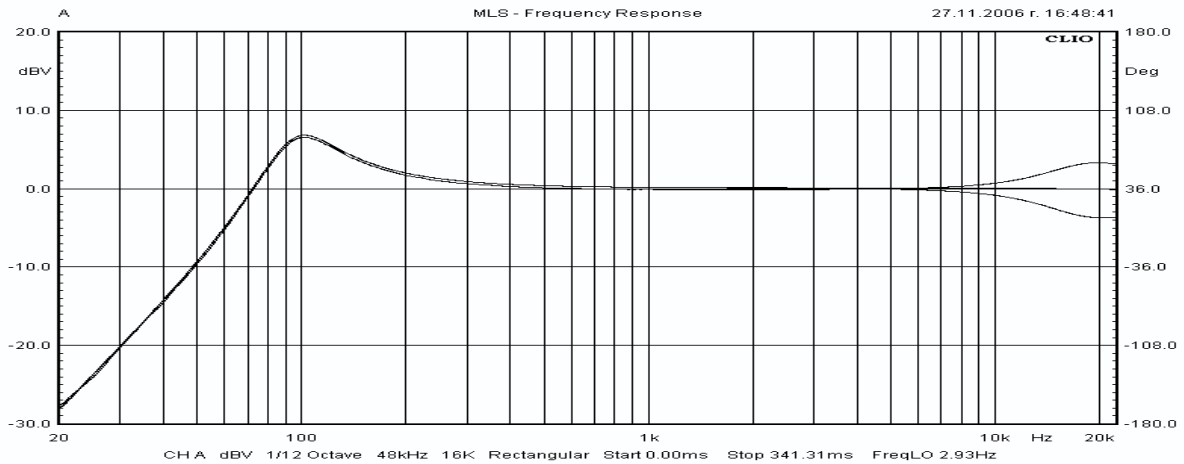

Mode Monitor

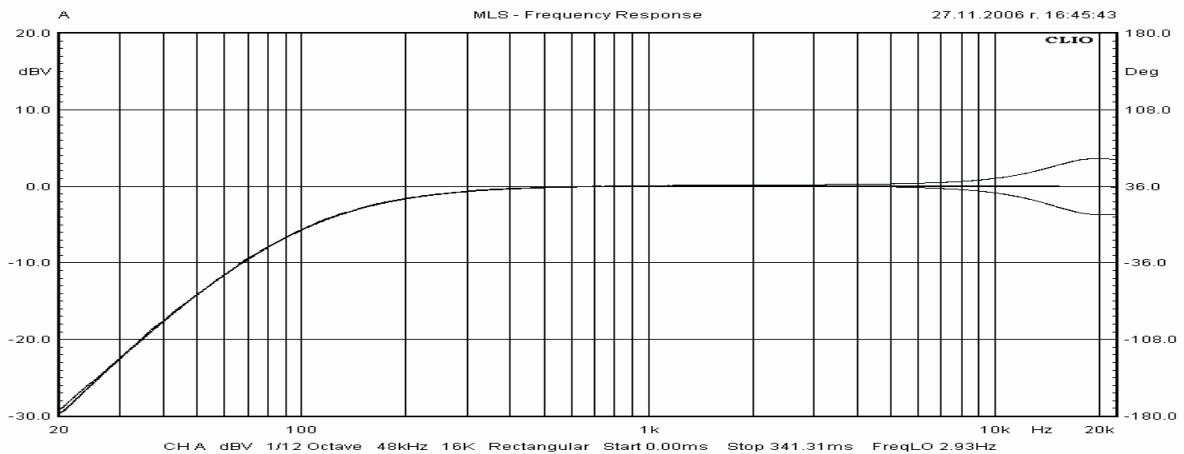

Coda Audio GmbH
Boulevard der EU 6
30539 Hannover
Germany
phone: +49-511-86655888
fax: 49-86655887
www.codaaudio.com